

service_team_name	Licensing Team
service_email_addresses	
Your Details	
Correspondence	
Correspondence Email	
Confirm Email	
Name	Bolney Wine Estate Ltd
Premises licence number	PWA0533
Premises	
Name of premises	Bolney Wine Estate
Does your premises have a postal address?	Yes
Postal address of premises or, if none, ordnance survey map reference or description	Bolney Wine Estate, Foxhole Lane Bolney, West Sussex RH17 5NB
Tel: (at premises)	
Email	
Non-domestic rateable value of premises.	£4301 - £33000
Current Premises Licence	
Please describe briefly, the nature of the proposed variation	We are adding a cafe and shop on the ground floor of our premises. Currently the first floor is fully licensed so we would like to extend this to the ground floor. there is no change to the licensable activities and times All current conditions attached to the license are appropriate and we don't consider further conditions are necessary There is no extension to the building. The current licensing hours on the ground floor are exactly the same as the first floor
Attach the premises licence (or relevant part of it)	
If you have not attached the premises licence or relevant part of it, please give your reasons:	
Applicant Details	
Current postal address if different	

from premises address	
Phone	
Email	
Operating Schedule	
Do you want the proposed variation to have effect as soon as possible?	Yes
Operating Schedule	
If the club's proposed variation would mean that 5,000 or more people are expected to attend the premises at any one time, please state the number expected to attend	400
Describe the premises. For example the type of premises, its general situation and layout and any other information which could be relevant to the licensing objectives. Where your application includes off-supplies of alcohol and you intend to provide a place for consumption of these off-supplies you must include a description of where the place will be and its proximity to the premises.	We are a working winery surrounded by vineyards. On site we also have a large retail space that has been a first floor restaurant and shop since 2019. We intend to develop this space on the ground floor to sell wine and spirits for consumption both on and off site. On site, we have facilities (tables and chairs) for consumers to drink alcohol. This area is both inside and outside.
Activities	
Plays	
Will you be provisioning Plays?	No
Monday	
Tuesday	
Wednesday	
Thursday	

Friday	
Saturday	
Sunday	
Films	
Will you be provisioning Films?	No
Monday	
Tuesday	
Wednesday	
Thursday	
Friday	
Saturday	
Sunday	
Indoor Sports	
Will you be provisioning Indoor Sporting events?	No
Monday	
Tuesday	
Wednesday	
Thursday	
Friday	
Saturday	
Sunday	
Boxing or wrestling	
Will you be provisioning boxing or wrestling events?	No
Monday	
Tuesday	
Wednesday	
Thursday	
Friday	
Saturday	
Sunday	
Live Music	
Will you be provisioning Live	Yes

Music?	
Monday	
Start Time	09:00
End Time	00:00
Tuesday	
Start Time	09:00
End Time	00:00
Wednesday	
Start Time	09:00
End Time	00:00
Thursday	
Start Time	09:00
End Time	00:00
Friday	
Start Time	09:00
End Time	00:00
Saturday	
Start Time	09:00
End Time	00:00
Sunday	
Start Time	10:00
End Time	23:00
Where will the performance of live music take place? Indoors may include a tent.	Indoors
Please state type of activity to be authorised, if not already stated, and give relevant further details, for example (but not exclusively) whether or not music will be amplified or unamplified.	Likely to be amplified and amplified music, to complement guests who are sitting and enjoying food and drink. i.e the music will not be intrusive
State any seasonal variations for performing live music: For example (but not exclusively)	More likely to be summer months

where the activity will occur on additional days during the summer months.	
Non standard timings. Where the premises intends to use the premises for the performance of live music at different times from those listed above, please list: For example (but not exclusively), where you wish the activity to go on longer on a particular day e.g. Christmas Eve.	
We don't envisage any non-standard timings	
Recorded Music	
Will you be provisioning Recorded Music?	
Yes	
Monday	
Start Time	09:00
End Time	00:00
Tuesday	
Start Time	09:00
End Time	00:00
Wednesday	
Start Time	09:00
End Time	00:00
Thursday	
Start Time	09:00
End Time	00:00
Friday	
Start Time	09:00
End Time	00:00
Saturday	
Start Time	09:00
End Time	00:00
Sunday	
Start Time	10:00

End Time	23:00
Where will the playing of recorded music take place? Indoors may include a tent.	Indoors
Please state type of activity to be authorised, if not already stated, and give relevant further details, for example (but not exclusively) whether or not music will be amplified or unamplified.	general popular music
State any seasonal variations for playing recorded music: For example (but not exclusively) where the activity will occur on additional days during the summer months.	
Non standard timings. Where the premises intends to use the premises for the playing of recorded music at different times from those listed above, please list: For example (but not exclusively), where you wish the activity to go on longer on a particular day e.g. Christmas Eve.	No non standard timings
Performances of dance	
Will you be provisioning Performances of dance?	No
Monday	
Tuesday	
Wednesday	
Thursday	
Friday	
Saturday	
Sunday	
Similar to live music, recorded music or performances of dance	

Will you be provisioning anything with a similar description to live music, recorded music or Performances of dance?

Monday

Tuesday

Wednesday

Thursday

Friday

Saturday

Sunday

Late Night Refreshment

Will you be provisioning any late night refreshment?

Monday

Start Time

End Time

Tuesday

Start Time

End Time

Wednesday

Start Time

End Time

Thursday

Start Time

End Time

Friday

Start Time

End Time

Saturday

Start Time

End Time

Sunday

Start Time

End Time	
Where will the provision of late night refreshment take place? Indoors may include a tent.	
State any seasonal variations: For example (but not exclusively) where late night refreshment is provided on additional days during the summer months.	
Non standard timings. Where the club intends to use the premises for the provision of late night refreshment at different times from those listed above, please list: For example (but not exclusively), where you wish the activity to go on longer on a particular day e.g. Christmas Eve.	
No non standard timings	
Supply of alcohol	
Will you be provisioning any alcohol?	Yes
Monday	
Start Time	09:00
End Time	00:00
Tuesday	
Start Time	09:00
End Time	00:00
Wednesday	
Start Time	09:00
End Time	00:00
Thursday	
Start Time	09:00
End Time	00:00
Friday	
Start Time	09:00
End Time	00:00
Saturday	
Start Time	09:00

End Time	00:00
Sunday	
Start Time	10:00
End Time	23:00
Where will the supplied alcohol be consumed?	Both on and off premises
State any seasonal variations : For example (but not exclusively) where the supply of alcohol will occur on additional days during the summer months.	
Non standard timings. Where the premises intends to use the premises for the supply of alcohol at different times from those listed above, please list: For example (but not exclusively), where you wish the activity to go on longer on a particular day e.g. Christmas Eve.	No no standard timings
Hours premises is open to the public	
Monday	
Start Time	09:00
End Time	00:00
Tuesday	
Start Time	09:00
End Time	00:00
Wednesday	
Start Time	09:00
End Time	00:00
Thursday	
Start Time	09:00
End Time	00:00
Friday	
Start Time	09:00
End Time	00:00
Saturday	
Start Time	09:00

End Time	00:00
Sunday	
Start Time	10:00
End Time	23:00
State any seasonal variations : For example (but not exclusively) where the supply of alcohol will occur on additional days during the summer months.	
Non standard timings. Where you intend to use the premises to be open at different times from those listed above, please list: For example (but not exclusively), where you wish the activity to go on longer on a particular day e.g. Christmas Eve.	
Current licence conditions	
Please identify those conditions currently imposed on the licence which you believe could be removed as a consequence of the proposed variation you are seeking.	no change to existing license which we believe could be removed as a consquence of the proposed variation
Adult Entertainment	
Please highlight any adult entertainment or services, activities, or other entertainment or matters ancillary to the use of the premises that may give rise to concern in respect of children.	None other than the consumption of alcohol
Licensing Objectives	
General - all four licensing objectives (b,c,d,e): Please list here steps you will take to promote all four licensing objectives together.	As a responsible business and employer we seek to operate responsibly, ethically and safely. We are conscientious members of the community. All team members are educated and trained to understand that we produce wine and sell wine and other alcoholic beverages in a responsible way. For example all employees are offered WSET training.
The prevention of	We promote and encourage the responsible consumption of alcohol. We

crime and disorder:	follow challenge 25 We seek to educate consumers on wine production and responsible consumption We do not sell alcohol to consumers who are clearly intoxicated. We have a refusal and incidence book
Public safety:	We have strict Health and Safety protocols in place and carry out risk assessments against existing and new risks. We have recently invested in first aid training and have over 12 members of the team who are trained first aiders. We have a defibrillation kit on site.
The prevention of public nuisance:	We have a rural location with few neighbors. As a working vineyard and winery, along with cafe, shop and restaurant. We work with our neighbors
The protection of children from harm:	We follow challenge 25 We have a safeguarding policy in place.
Submit & Pay	
Name	james Davis
Address for correspondence associated with this application	
Phone	
Email	

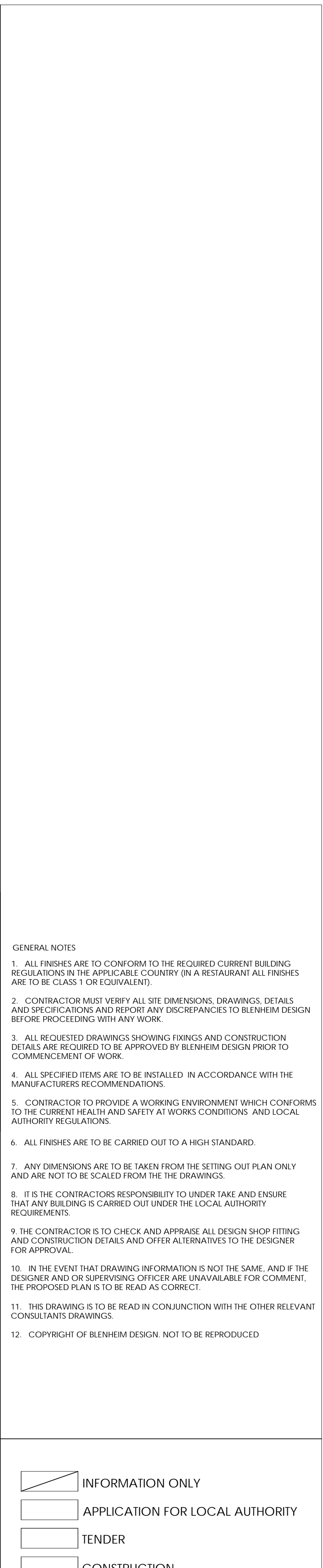

<input checked="" type="checkbox"/>	INFORMATION ONLY
<input type="checkbox"/>	APPLICATION FOR LOCAL AUTHORITY
<input type="checkbox"/>	TENDER
<input type="checkbox"/>	CONSTRUCTION

REVISION	DATE	ITEM
D	31/01/2023	CASH DESK MOVED AS PER MEETING 30/01/2023
C	24/01/2023	WASH UP ROOM WALL MOVED
B	06/01/2023	RIPLE WINDOW ADDED
A	12/12/2022	door arrangement change to suit catering

PROJECT
BOLNEY WINEYARD, Foxhole Ln,
Bolney, Haywards Heath RH17 5NB

TITLE	PROPOSED GENERAL ARRANGEMENT PHASE 1
-------	---

DRAWN	DATE	SCALE	CHECKED
MM	29/11/2022	as shown	
PROJECT		NUMBER	REVISION
BD 22167		02-01	D

BLenheim
DESIGN

HOSPITALITY AND RETAIL

Suite 1, 3rd Floor Vantage Point
Brighton, BN1 4GW
t: 07866 770 525
maja@blenheimdesign.com

OCCUPANCY LEVEL:

CAFE: 30
OUTSIDE SEATING: 23
WINE TOUR ROOMS: 36
TOTAL GROUND FLOOR OCCUPANCY: 89 + SHOP

TOILET OCCUPANCY SUITABLE FOR 180 COVERS

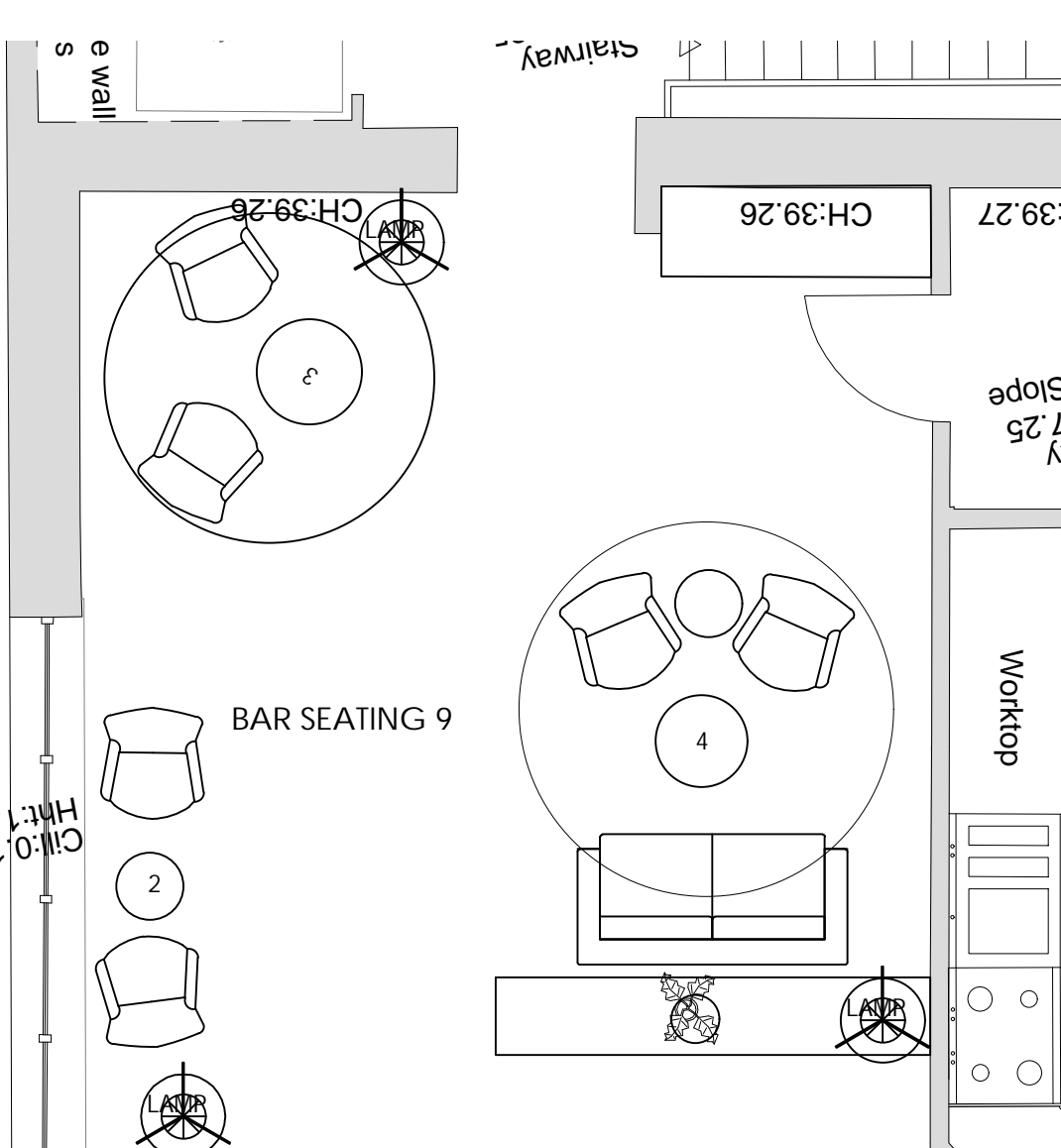

PROPOSED BAR SEATING AREA (FIRST FLOOR)

