



which it is proposed to have furniture on the highway	Monday, Tuesday, Wednesday, Thursday, Friday, Saturday, Sunday
Monday from	08:00
Monday to	22:00
Tuesday from	08:00
Tuesday to	22:00
Wednesday from	08:00
Wednesday to	22:00
Thursday from	08:00
Thursday to	22:00
Friday from	08:00
Friday to	22:00
Saturday from	08:00
Saturday to	22:00
Sunday from	08:00
Sunday to	22:00
Label	
Describe the type of furniture to which the application relates	Same as last year: 30 Plastic Chairs 10 Foldable Tables 4 Planters on wheels and movable (not obstructing pathway) these are instead of the fabric barriers applied for last time 4 Parasols bases and umbrellas Seasonal Ice Cream Trolley

## Supporting Documents

Are the plan or photos of the furniture planned different from the existing licence.	No

## Details

The proposed duration of the licence 2 Years	
Date	10/06/2026
All information provided in this form is true and accurate to the best of my knowledge.	Yes

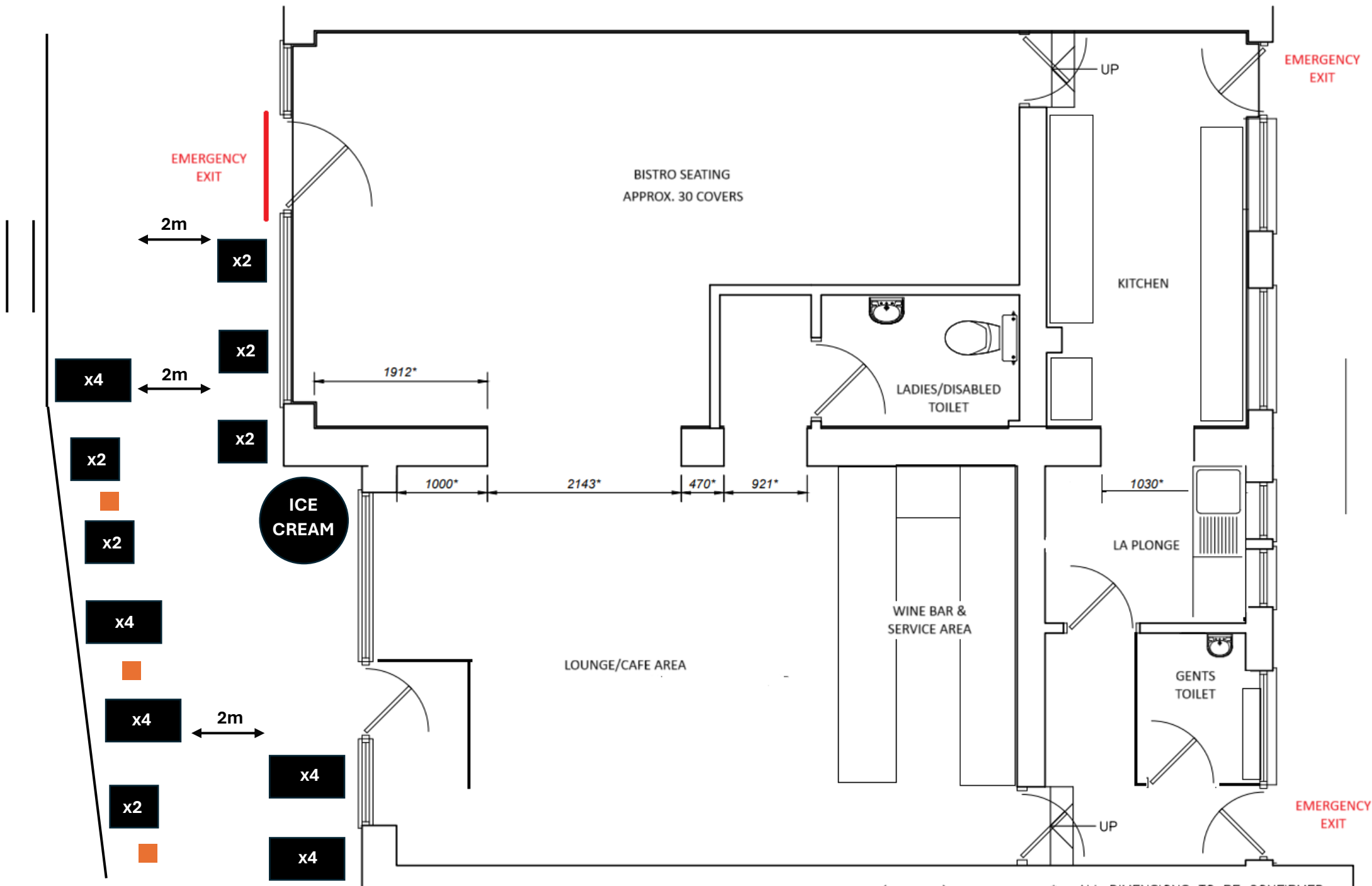

■ = PARASOL

PROPOSED GROUND FLOOR PLAN (NTS)

12/03/2024

\* ALL DIMENSIONS TO BE CONFIRMED FOLLOWING DETAILED DESIGN.

