

1

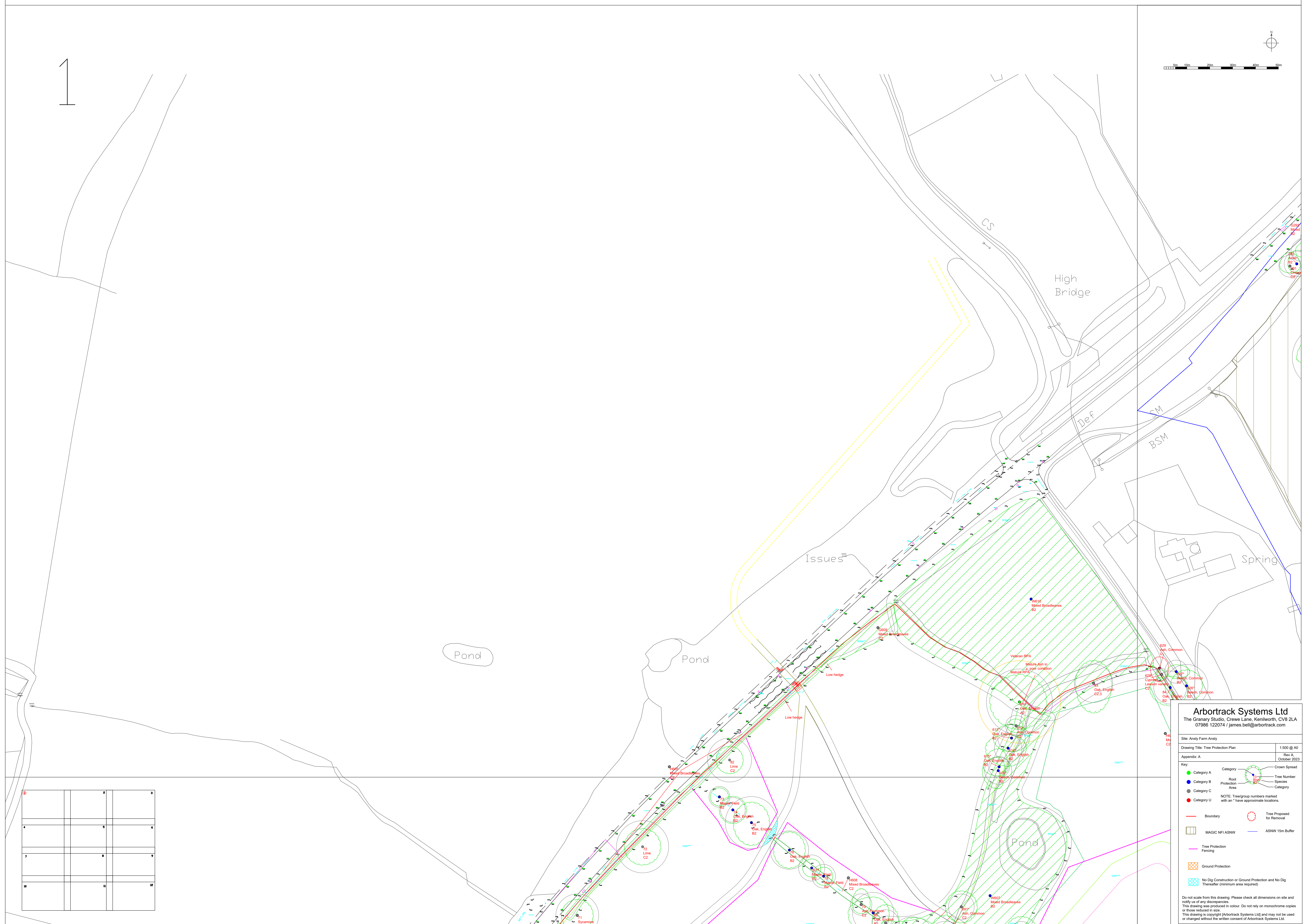
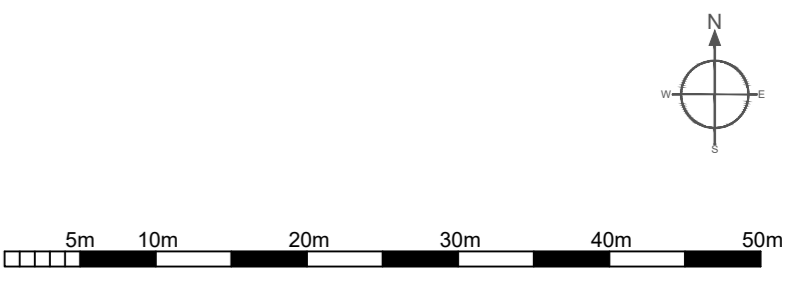

10				
11				
12				
13				
14				

Arbortrack Systems Ltd
 The Granary Studio, Crewe Lane, Kenilworth, CV8 2LA
 07986 122074 / james.bell@arbortrack.com

Site: Ansty Farm Ansty
 Drawing Title: Tree Protection Plan
 Appendix: A
 Scale: 1:500 @ A0
 Rev: A
 Date: October 2023

Key:

- Category A: Crown Spread
- Category B: Root Protection Area
- Category C: Tree
- Category U: Tree Proposed for Removal
- Boundary: Boundary
- MAGIC NFASW: MAGIC NFASW
- Tree Protection Fencing: Tree Protection Fencing
- Ground Protection: Ground Protection
- No Dig Construction or Ground Protection and No Dig Threshold (minimum area required): No Dig Construction or Ground Protection and No Dig Threshold (minimum area required)
- Tree Number: Tree Number
- Species: Species
- Category: Category
- NOTE: Treegroup numbers marked with an * have approximate locations.

Do not scale from this drawing. Please check all dimensions on site and notify us of any discrepancies. This drawing was produced in colour. Do not rely on monochrome copies or those reduced in size. This drawing is copyright Arbortrack Systems Ltd and may not be used or changed without the written consent of Arbortrack Systems Ltd.

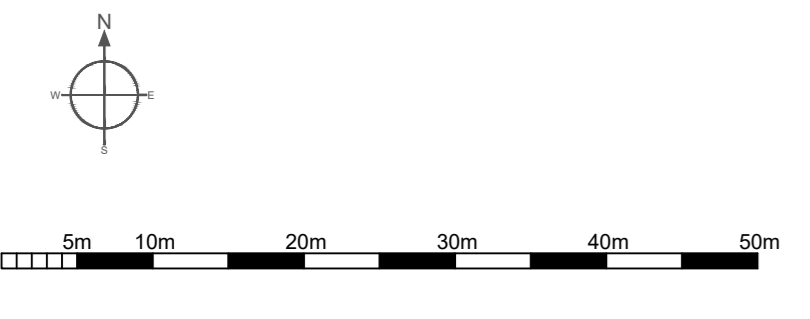

2

1	2	3
4	5	6
7	8	9
10	11	12

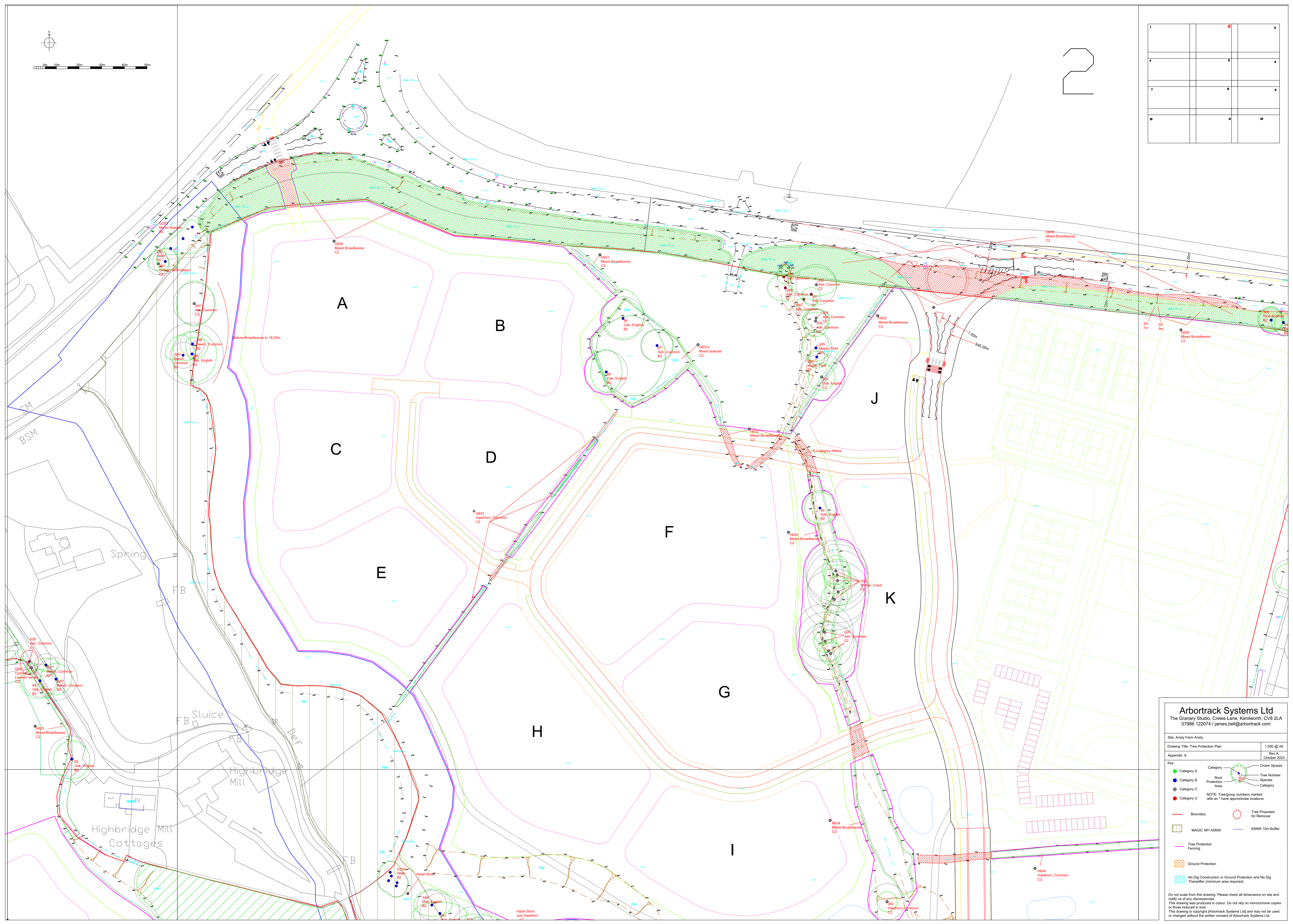

Arbortrack Systems Ltd
 The Granary Studio, Crewe Lane, Kenilworth, CV8 2LA
 07986 122074 / james.bell@arbortrack.com

Site: Ansty Farm Ansty
 Drawing Title: Tree Protection Plan
 Appendix: A
 Scale: 1:500 @ A0
 Rev: A, October 2023

Key:

- Category A (Green circle)
- Category B (Blue circle)
- Category C (Red circle)
- Category U (Black circle)
- Category (Red circle)
- Crown Spread (Green circle)
- Tree Number (Number in circle)
- Species (Text)
- Root Protection Area (Red circle)
- Tree Proposed for Removal (Red circle with slash)
- Boundary (Red line)
- MAGIC NFI ASNW (Green hatched area)
- Tree Protection Fencing (Pink line)
- Ground Protection (Orange hatched area)
- No Dig Construction or Ground Protection and No Dig Thereafter (Blue hatched area)
- ASNW 15m Buffer (Blue line)

NOTE: Tree group numbers marked with an 'I' have approximate locations.

Do not scale from this drawing. Please check all dimensions on site and notify us of any discrepancies. This drawing was produced in AutoCAD. Do not rely on monochrome copies or those reduced in size. This drawing is copyright © Arbortrack Systems Ltd and may not be used or changed without the written consent of Arbortrack Systems Ltd.

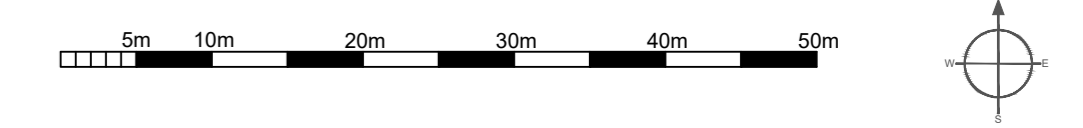

3

1	2	3
4	5	6
7	8	9
10	11	12

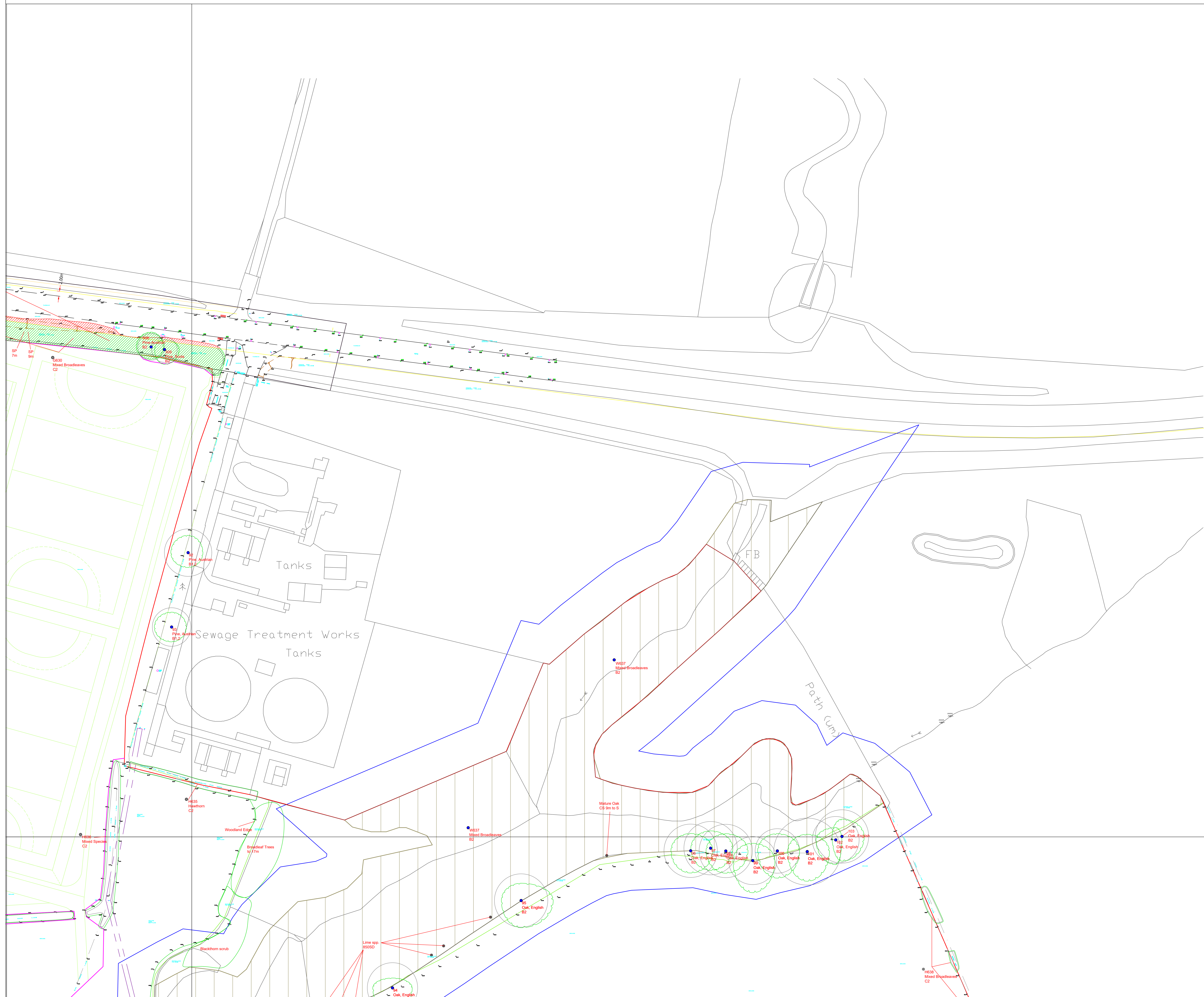

Arbortrack Systems Ltd
 The Granary Studio, Crewe Lane, Kenilworth, CV8 2LA
 07986 122074 / james.bell@arbortrack.com

Site: Ansty Farm Ansty
 Drawing Title: Tree Protection Plan
 Appendix: A
 1:500 @ A0
 Rev A
 October 2023

Key:

- Category A (Green dot)
- Category B (Blue dot)
- Category C (Red dot)
- Category U (Red dot with asterisk)
- Crown Spread (Green circle)
- Tree Number (Number next to dot)
- Species (Text next to dot)
- Category (Text next to dot)
- Tree Proposed for Removal (Red dashed circle)
- Boundary (Red line)
- MAGIC NFI ASNW (Hatched area)
- Tree Protection Area (Blue line)
- ASNW 15m Buffer (Blue line)
- Tree Protection Fencing (Pink line)
- Ground Protection (Orange hatched area)
- No Dig Construction or Ground Protection and No Dig Thereafter (Minimum area required) (Blue hatched area)

NOTE: Tree/group numbers marked with an * have approximate locations.

Do not scale from this drawing. Please check all dimensions on site and notify us of any discrepancies. This drawing was produced in colour. Do not rely on monochrome copies or those reduced in size. This drawing is copyright (Arbortrack Systems Ltd) and may not be used or changed without the written consent of Arbortrack Systems Ltd.

1	2	3
4	5	6
7	8	9
10	11	12

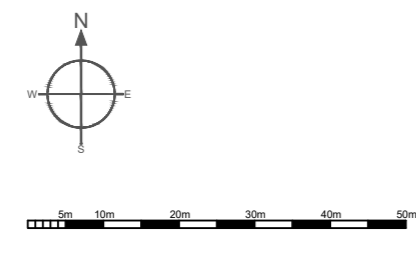

4



Arbortrack Systems Ltd
 The Granary Studio, Crewe Lane, Kenilworth, CV8 2LA
 07986 122074 / james.bell@arbortrack.com

Site: Ansty Farm Ansty
 Drawing Title: Tree Protection Plan
 Appendix: A
 1:500 @ A0
 Rev. A
 October 2023

Key:

- Category A (Green circle)
- Category B (Blue circle)
- Category C (Red circle)
- Category U (Black circle)
- Boundary (Red line)
- MAGIC NFI ASNW (Yellow hatched area)
- Tree Protection Fencing (Pink line)
- Ground Protection (Blue hatched area)
- No Dig Construction or Ground Protection and No Dig Thereafter (Minimum area required) (Blue hatched area)
- Tree Number (Number in circle)
- Tree Protection Area (Number in circle)
- Tree Proposed for Removal (Red circle with 'X')
- Crown Spread (Green circle)
- Tree Number Categories (Number in circle)

NOTE: Tree group numbers marked with an * have approximate locations.

Do not scale from this drawing. Please check all dimensions on site and notify us of any discrepancies. This drawing was produced in colour. Do not rely on monochrome copies or those reduced in size. This drawing is copyright [Arbortrack Systems Ltd] and may not be used or changed without the written consent of Arbortrack Systems Ltd.

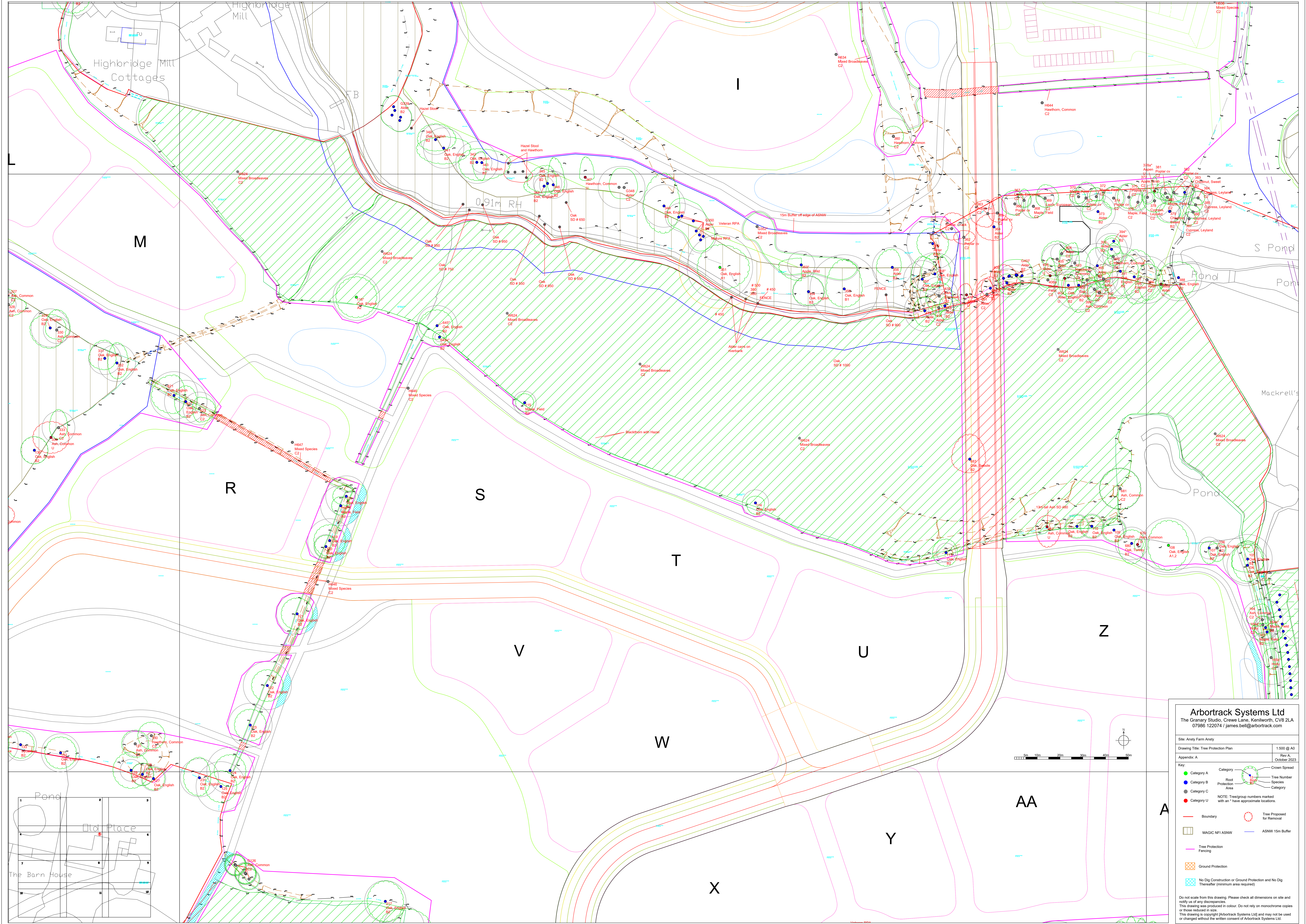

Arbortrack Systems Ltd
 The Granary Studio, Crewe Lane, Kenilworth, CV8 2LA
 07986 122074 / james.bell@arbortrack.com

Site: Ansty Farm Ansty
 Drawing Title: Tree Protection Plan
 Appendix: A
 Scale: 1:500 @ A0
 Rev A, October 2023

Key:

- Category A: Green circle with crown spread
- Category B: Blue circle with crown spread
- Category C: Red circle with crown spread
- Category U: Red circle with crown spread
- Tree Number: Line with number
- Species: Line with species name
- Category: Line with category letter
- Boundary: Solid red line
- MAGIC NFI ASNW: Hatched area
- Tree Protection Area: Dotted area
- Ground Protection: Hatched area
- No Dig Construction or Ground Protection and No Dig Thereafter: Blue hatched area
- Tree Proposed for Removal: Red circle with 'X'
- ASNW 15m Buffer: Blue line

NOTE: Tree/prop numbers marked with an * have approximate locations.

Do not scale from this drawing. Please check all dimensions on site and notify us of any discrepancies. This drawing was produced in colour. Do not rely on monochrome copies or those reduced in size. This drawing is copyright (Arbortrack Systems Ltd) and may not be used or changed without the written consent of Arbortrack Systems Ltd.

1	2	3
4	5	6
7	8	9
10	11	12

6

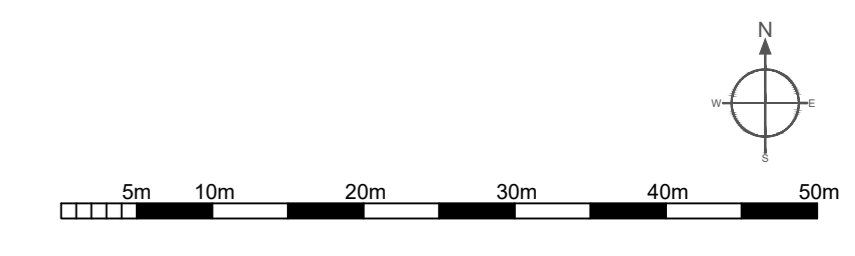
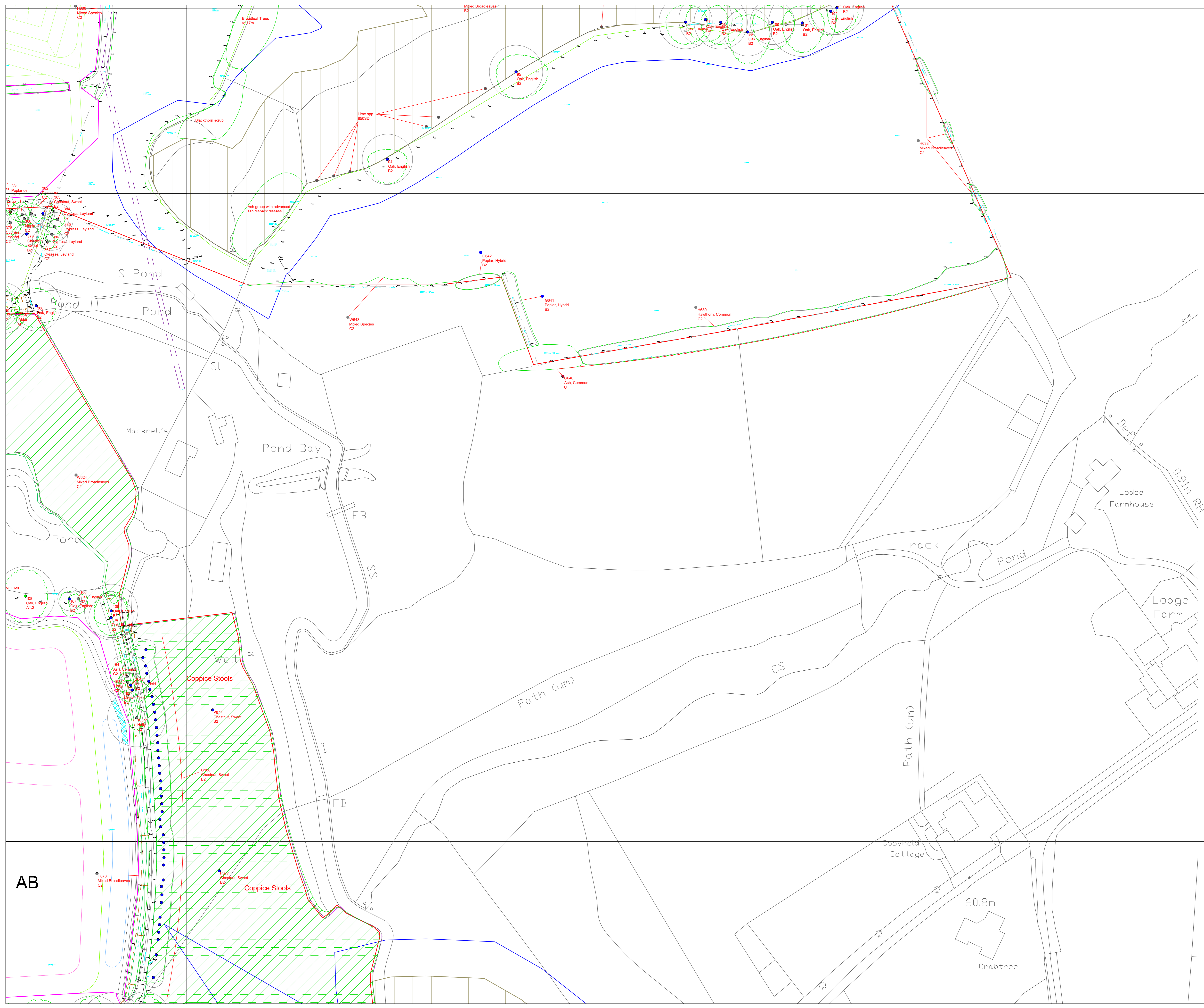

Arbortrack Systems Ltd
 The Granary Studio, Crewe Lane, Kenilworth, CV8 2LA
 07986 122074 / james.bell@arbortrack.com

Site: Andy Farm Andy
 Drawing Title: Tree Protection Plan 1:500 @ A0
 Appendix: A Rev A October 2023

Key:

- Category A (Green dot)
- Category B (Blue dot)
- Category C (Grey dot)
- Category U (Red dot)
- Category (Red dot with 'X')
- Crown Spread (Green circle)
- Tree Number (Number)
- Species (Text)
- Root Protection Area (Red circle)
- Boundary (Red line)
- MAGIC NFI ASNW (Hatched area)
- Tree Protection Fencing (Purple line)
- Ground Protection (Orange hatched area)
- No Dig Construction or Ground Protection and No Dig Thereafter (Minimum area required) (Blue hatched area)
- Tree Proposed for Removal (Red circle with 'X')
- ASNW 15m Buffer (Blue line)

NOTE: Treegroup numbers marked with an * have approximate locations.

Do not scale from this drawing. Please check all dimensions on site and notify us of any discrepancies.
 This drawing was produced in colour. Do not rely on monochrome copies or those reduced in size.
 This drawing is copyright (Arbortrack Systems Ltd) and may not be used or changed without the written consent of Arbortrack Systems Ltd.

AB

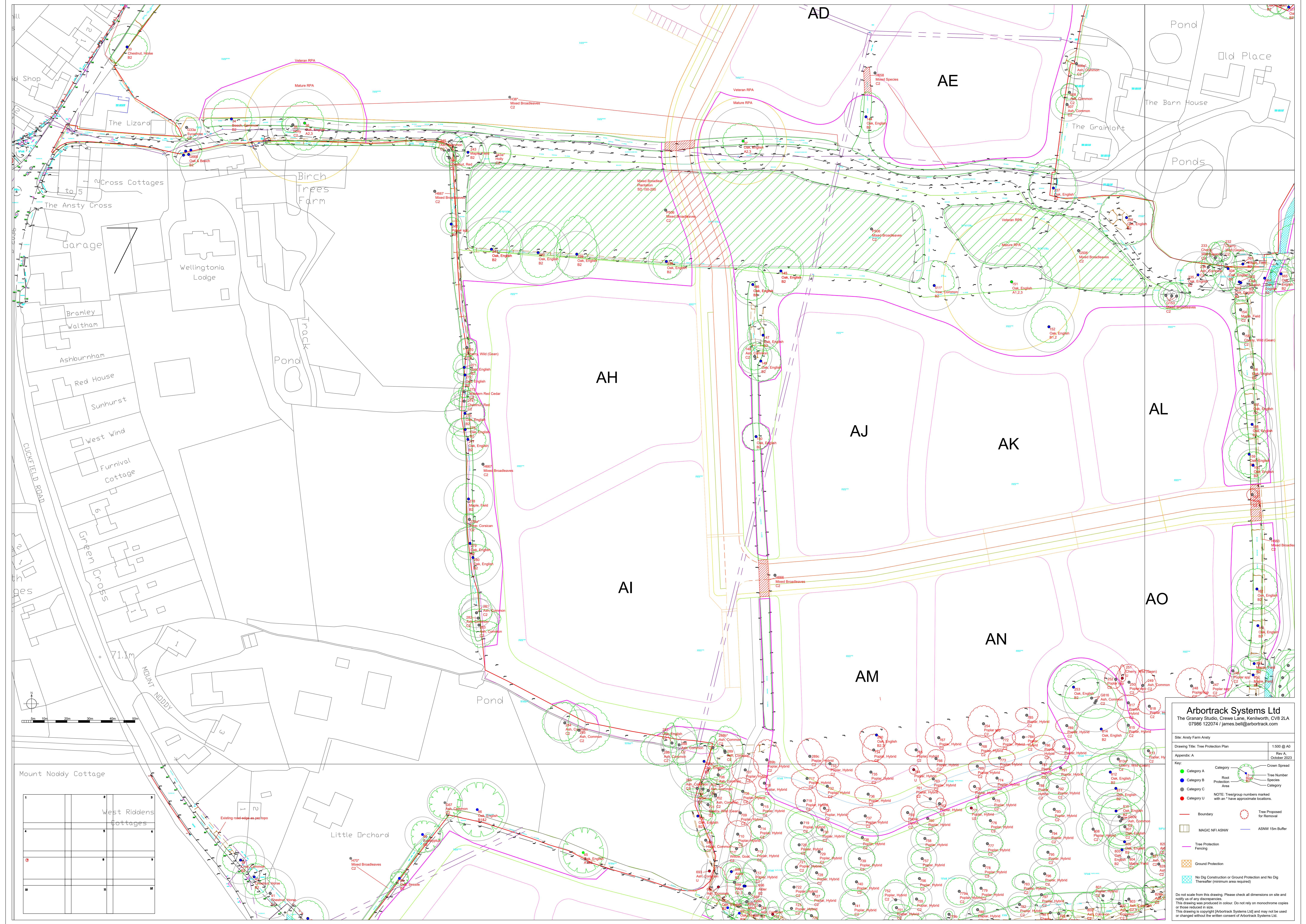

1	2	3
4	5	6
7	8	9
10	11	12

Arbortrack Systems Ltd
 The Granary Studio, Crewe Lane, Kenilworth, CV8 2LA
 07986 122074 / james.bell@arbortrack.com

Site: Ansty Farm Ansty
 Drawing Title: Tree Protection Plan
 Drawing Scale: 1:500 @ A0
 Appendix: A
 Rev A, October 2023

Key:

- Category A: Green circle with crown spread and tree number
- Category B: Blue circle with crown spread and tree number
- Category C: Grey circle with crown spread and tree number
- Category U: Red circle with crown spread and tree number
- Tree Proposed for Removal: Red dashed circle
- Boundary: Red line
- MAGIC NFASNW: Yellow hatched area
- Tree Protection Fencing: Purple line
- Ground Protection: Blue hatched area
- No Dig Construction or Ground Protection and No Dig Threshold (minimum area required): Blue dashed line
- ASNW 15m Buffer: Blue dashed line
- Crown Spread: Green dashed line
- Tree Number: Blue text
- Species: Green text
- Category: Blue text

NOTE: Tree/ground numbers marked with an * have approximate locations.

Do not scale from this drawing. Please check all dimensions on site and notify us of any discrepancies.
 This drawing was produced in colour. Do not rely on monochrome copies or those reduced in size.
 This drawing is copyright (Arbortrack Systems Ltd) and may not be used or changed without the written consent of Arbortrack Systems Ltd.

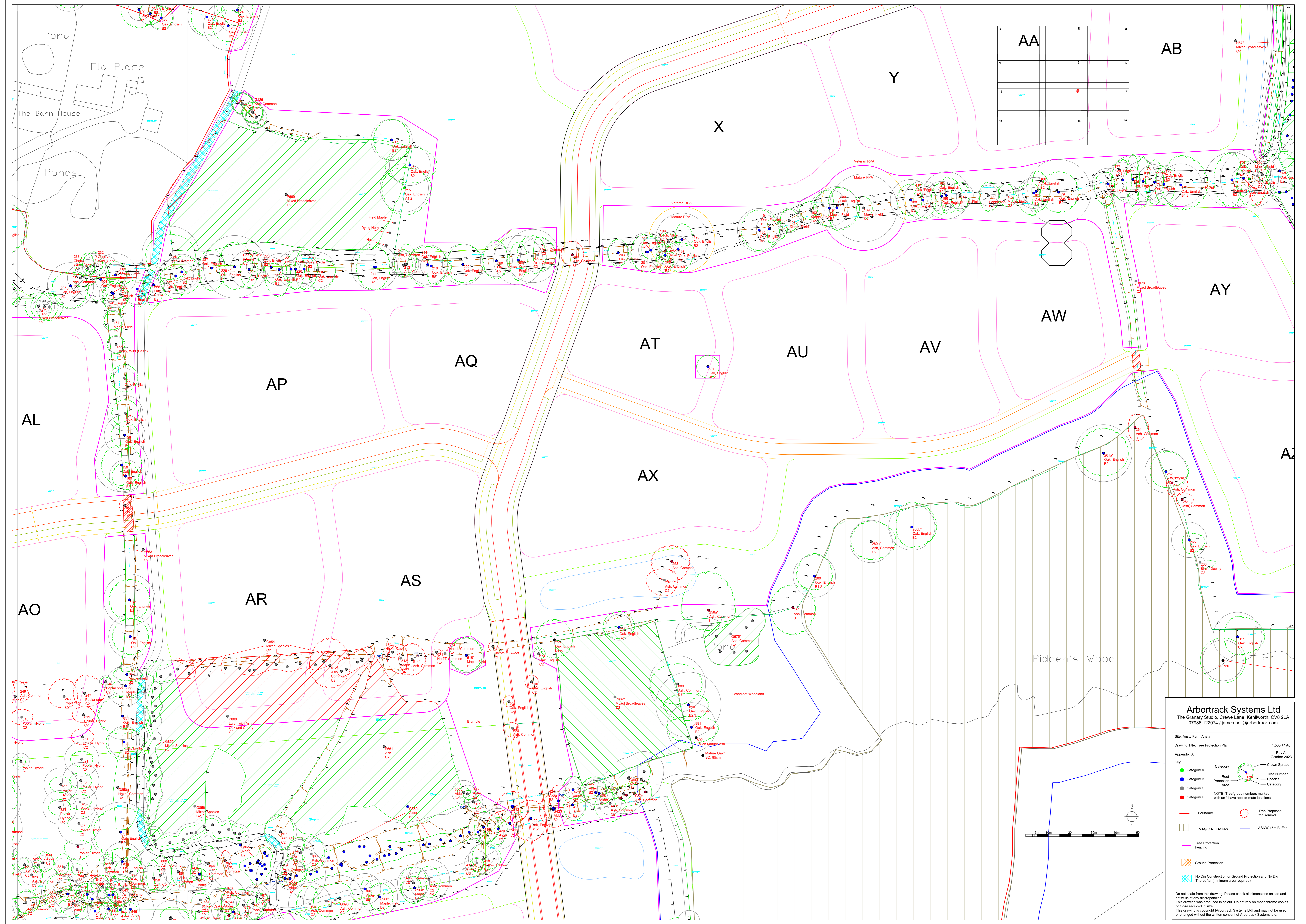

1	AA	2	3
4		5	6
7			8
10			11

Arbortrack Systems Ltd
 The Granary Studio, Crewe Lane, Kenilworth, CV8 2LA
 07986 122074 / james.bell@arbortrack.com

Site: Ansty Farm Ansty
 Drawing Title: Tree Protection Plan
 Appendix: A

Scale: 1:500 @ A0
 Rev A, October 2023

Key:

- Category A: Green circle
- Category B: Blue circle
- Category C: Red circle
- Category U: Red circle with asterisk
- Boundary: Red line
- MAGIC NFI ASNW: Yellow hatched area
- Tree Protection Area: Purple line
- Ground Protection: Orange hatched area
- No Dig Construction or Ground Protection and No Dig Threshold (minimum area required): Blue hatched area
- Crown Spread: Red dashed circle
- Tree Number: Red dot
- Species: Red text
- Category: Red text
- Tree Proposed for Removal: Red circle with 'X'
- ASNW 15m Buffer: Blue line

NOTE: Tree/group numbers marked with an * have approximate locations.

Do not scale from this drawing. Please check all dimensions on site and notify us of any discrepancies.
 This drawing was produced in colour. Do not rely on monochrome copies or those reduced in size.
 This drawing is copyright (Arbortrack Systems Ltd) and may not be used or changed without the written consent of Arbortrack Systems Ltd.

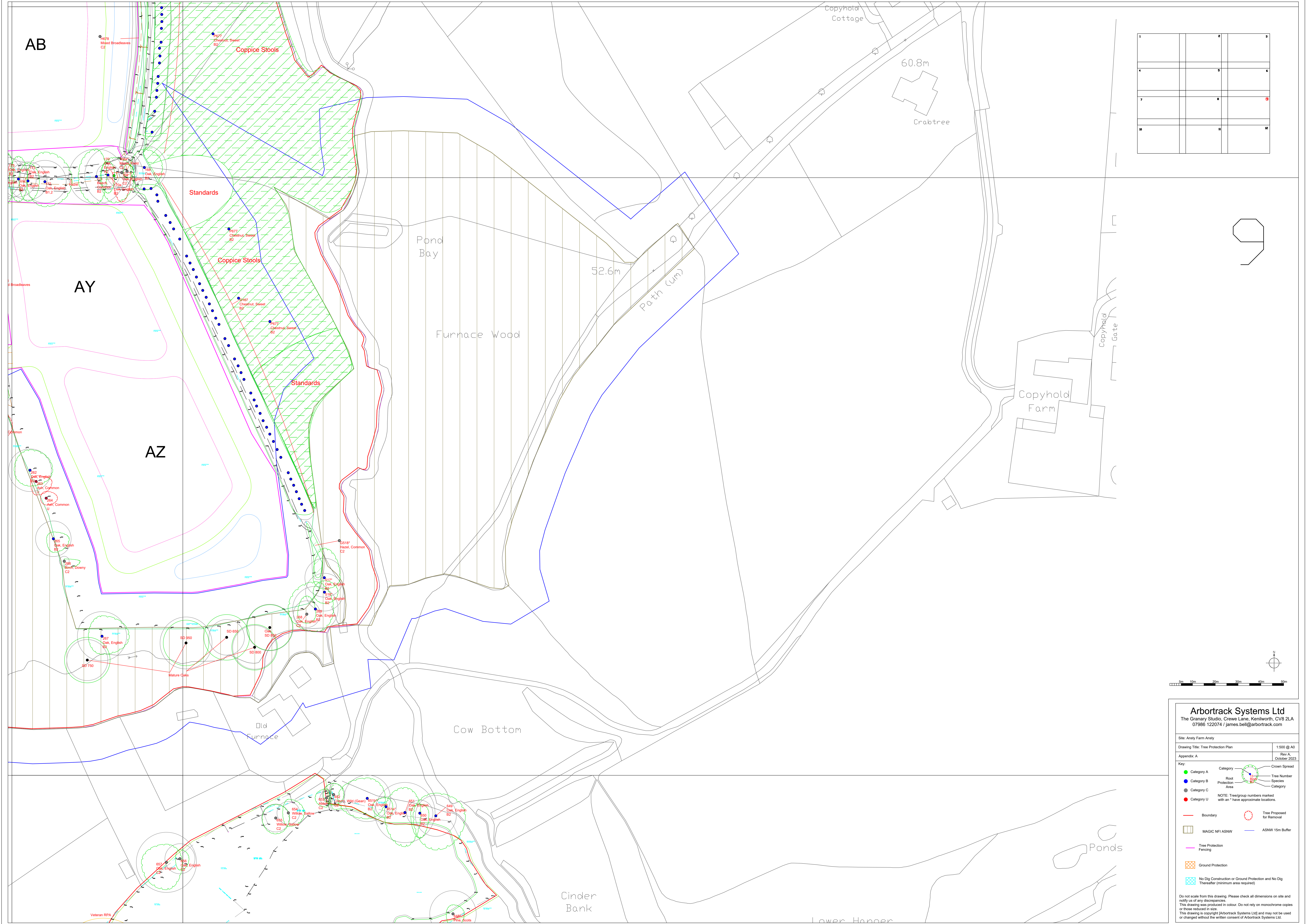

1	2	3
4	5	6
7	8	9
10	11	12

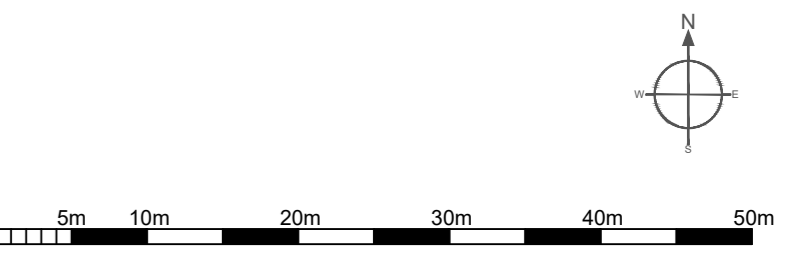
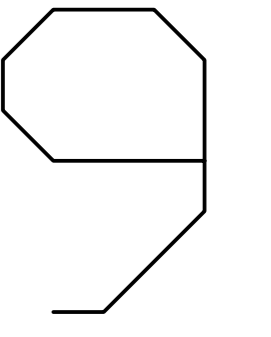

Arbortrack Systems Ltd
 The Granary Studio, Crewe Lane, Kenilworth, CV8 2LA
 07986 122074 | james.bell@arbortrack.com

Site: Ansty Farm Ansty
 Drawing Title: Tree Protection Plan 1:500 @ A0
 Appendix: A Rev A, October 2023

- Key:**
- Category A
 - Category B
 - Category C
 - Category U
 - Crown Spread
 - Tree Number
 - Species
 - Category
 - Root Protection Area
 - Tree Proposed for Removal
 - ASNW 15m Buffer
 - Boundary
 - MAGIC NFI ASNW
 - Tree Protection Fencing
 - Ground Protection
 - No Dig Construction or Ground Protection and No Dig Threshold (minimum area required)
- NOTE: Tree/strip numbers marked with an * have approximate locations.

Do not scale from this drawing. Please check all dimensions on site and notify us of any discrepancies.
 This drawing was produced in colour. Do not rely on monochrome copies or those reduced in size.
 This drawing is copyright Arbortrack Systems Ltd and may not be used or changed without the written consent of Arbortrack Systems Ltd.

Mount Noddy Cottage

West Riddens Cottages

Little Orchard

BA

BB

BC

BD

BE

10

Ansty Lodge

BF

BG

BH

Anstye Place

61.7m

Pond

Pond

West Riddens Farm

West Riddens

Pond

Oak Tree Farm

68.2m

1	2	3	4
5	6	7	8
9	10	11	12
13	14	15	16

Arbortrack Systems Ltd
 The Granary Studio, Crewe Lane, Kenilworth, CV8 2LA
 07986 122074 / james.bell@arbortrack.com

Site: Ansty Farm Ansty
 Drawing Title: Tree Protection Plan
 Appendix: A
 Scale: 1:500 @ A0
 Rev A, October 2023

Key:

- Category A (Green circle)
- Category B (Blue circle)
- Category C (Red circle)
- Category U (Black circle)
- Tree Number (Number in circle)
- Species (Text next to tree number)
- Category (Text next to tree number)
- Tree Proposed for Removal (Red dashed circle)
- Boundary (Red line)
- MAGIC NFI ASNW (Green hatched area)
- Tree Protection Fencing (Pink dashed line)
- Ground Protection (Orange hatched area)
- No Dig Construction or Ground Protection and No Dig Thereafter (Minimum area required) (Blue hatched area)
- ASNW 15m Buffer (Blue line)
- Crown Spread (Green dashed line)
- Root Protection Area (Red dashed line)

NOTE: Tree group numbers marked with an '1' have approximate locations.

Do not scale from this drawing. Please check all dimensions on site and notify us of any discrepancies. This drawing was produced in colour. Do not rely on monochrome copies or those reduced in size. This drawing is copyright (Arbortrack Systems Ltd) and may not be used or changed without the written consent of Arbortrack Systems Ltd.

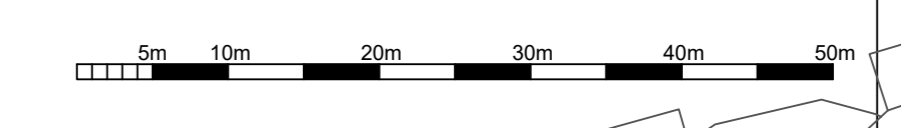

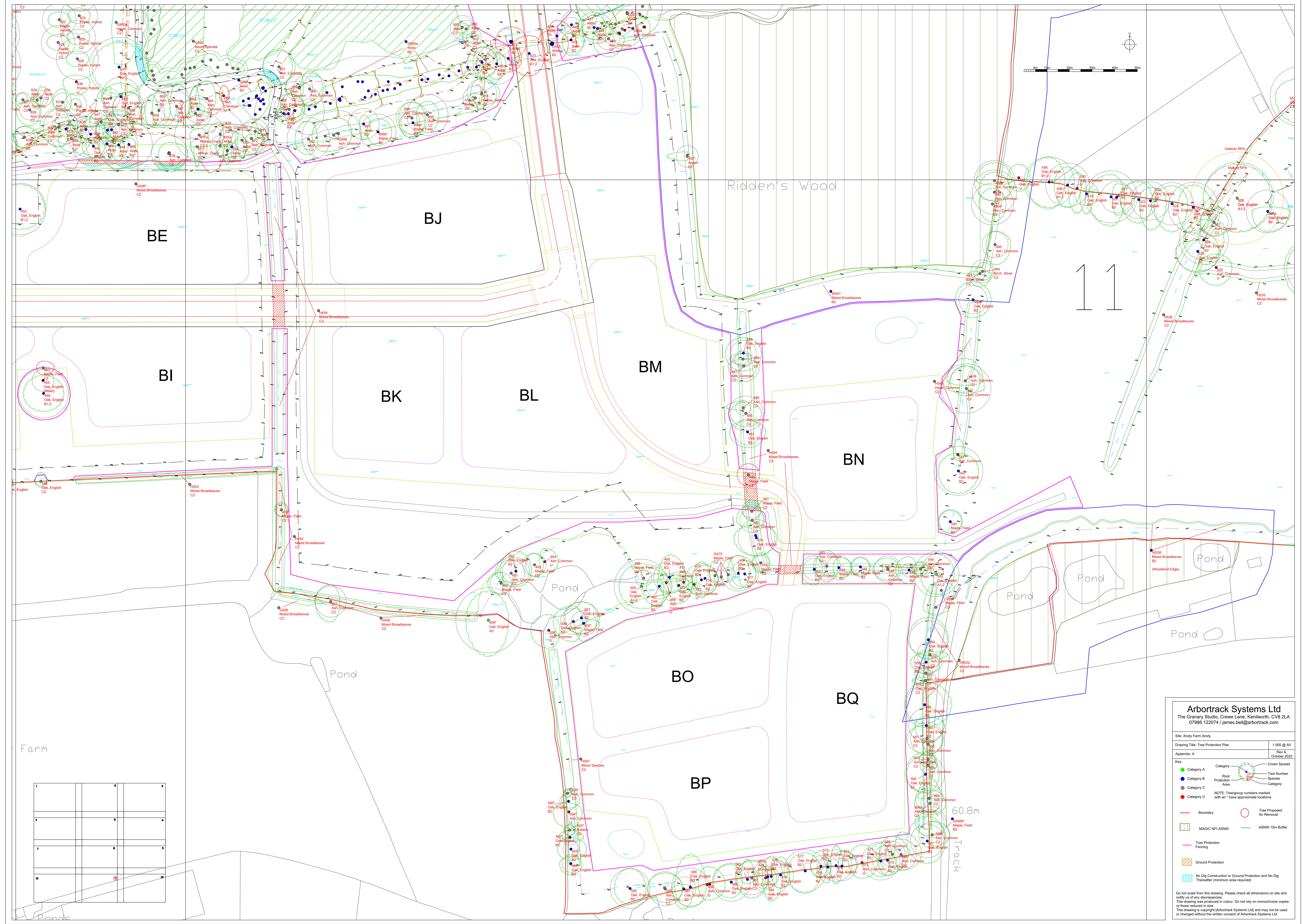

1	2	3	4
5	6	7	8
9	10	11	12
13	14	15	16

Arbortrack Systems Ltd
 The Granary Studio, Crewe Lane, Kenilworth, CV8 2LA
 07986 122074 / james.bell@arbortrack.com

Site: Ansty Farm Ansty
 Drawing Title: Tree Protection Plan
 Appendix: A

1:500 @ A0
 Rev A
 October 2023

Key:

- Category A: Crown Spread
- Category B: Root Protection Area
- Category C: Tree Number
- Category U: Species
- Tree Proposed for Removal: Tree Number
- Tree Number: Species
- Species: Category

NOTE: Treegroup numbers marked with an * have approximate locations.

- Boundary
- MAGIC NFI ASNW
- Tree Protection Fencing
- Ground Protection
- No Dig Construction or Ground Protection and No Dig Threshold (minimum area required)
- Tree Proposed for Removal
- ASNW 15m Buffer

Do not scale from this drawing. Please check all dimensions on site and notify us of any discrepancies.
 This drawing was produced in colour. Do not rely on monochrome copies or those reduced in size.
 This drawing is copyright Arbortrack Systems Ltd and may not be used or changed without the written consent of Arbortrack Systems Ltd.



1				
4				
7				
10				

12

Arbortrack Systems Ltd
 The Granary Studio, Crewe Lane, Kenilworth, CV8 2LA
 07986 122074 / james.bell@arbortrack.com

Site: Ansty Farm Ansty
 Drawing Title: Tree Protection Plan
 Appendix: A

1:500 @ A0
 Rev A
 October 2023

Key

- Category A (Green dot)
- Category B (Blue dot)
- Category C (Grey dot)
- Category U (Red dot)
- Tree Number
- Species
- Category
- Boundary (Red line)
- MAGIC NFI ASNW (Hatched box)
- Tree Protection Fencing (Pink dashed line)
- Ground Protection (Orange hatched box)
- No Dig Construction or Ground Protection and No Dig (Blue hatched box)
- Tree Proposed for Removal (Red dashed circle)
- ASNW 15m Buffer (Blue line)

NOTE: Tree/group numbers marked with an * have approximate locations.

Do not scale from this drawing. Please check all dimensions on site and notify us of any discrepancies. This drawing was produced in colour. Do not rely on monochrome copies or those reduced in size. This drawing is copyright [Arbortrack Systems Ltd] and may not be used or changed without the written consent of Arbortrack Systems Ltd.

