

Form	Application for a premises licence
service_team_name	
service_email_address	
Name/s:	My Diamond Catering Ltd
Postal address of premises or, if none, ordnance survey map reference or description:	25-27 Station Road Burgess Hill RH15 9DE
Postcode	RH15 9DE
Phone (at premises)	
Email	
Non-domestic rateable value of premises.	£33001 - £87000
Plan of premises	
Please state whether you are applying for a premises licence as:	a person other than an individual - i) as a limited company
Please confirm:	I am carrying on or proposing to carry on a business which involves the use of the premises for licensable activities
Title: (e.g. Mr/Mrs)	
Name	
Address	
Postcode	
Email	
18 or over-I am 18 years old or over	no
Nationality	
Is there a second individual applicant?	
Title: (e.g. Mr/Mrs)	
Name	
Address	
Postcode	
Email	
second app 18 or over-I am 18 years old or over	no
Nationality	
Name	My Diamond Catering Ltd
Address	
Postcode	
Registered number (where applicable)	13068935
Description	Limited Company

Phone

Email

When do you want the premises licence to start? 02/08/2021

If 5,000 or more people are expected to attend the premises at any one time, please state the number expected to attend.

Description The site has been a restaurant for the past 15 years. The previous owners closed and surrendered the licence. This application is being made by new owners to the area but are very experienced in running restaurants. It will be an Italian Restaurant called Mio Gusto and the application seeks the same hours as the premises were previously licensed for.

Will you be provisioning Plays? No

Where will the performance of the play take place? Indoors may include a tent.

Please state type of activity to be authorised, if not already stated, and give relevant further details, for example (but not exclusively) whether or not music will be amplified or unamplified.

State any seasonal variations for performing plays: For example (but not exclusively) where the activity will occur on additional days during the summer months.

Non standard timings. Where the premises intends to use the premises for the performance of a play at different times from those listed above, please list: For example (but not exclusively), where you wish the activity to go on longer on a particular day e.g. Christmas Eve.

Will you be provisioning Films? No

Where will the exhibition of the film take place? Indoors may include a tent.

Please state type of activity to be authorised, if not already stated, and give relevant further details, for example (but not exclusively) whether or not music will be amplified or unamplified.

State any seasonal variations for the exhibition of the film: For example (but not exclusively) where the activity will occur on additional days during the summer months.

Non standard timings. Where the premises intends to use the premises for the exhibition of the film at different times from those listed above, please list: For example (but not exclusively), where you wish the activity to go on longer on a particular day e.g. Christmas Eve.

Will you be provisioning Indoor Sporting events? No

Please state type of activity to be authorised, if not already stated, and give relevant further details, for example (but not exclusively) whether or not music will be amplified or unamplified.

State any seasonal variations for indoor sporting events: For example (but not exclusively) where the activity will occur on additional days during the summer months.

Non standard timings. Where the premises intends to use the premises for indoor sporting events at different times from those listed above, please list: For example (but not exclusively), where you wish the activity to go on longer on a particular day e.g. Christmas Eve.

Will you be provisioning boxing or wrestling events? No

Where will the boxing or wrestling entertainment take place? Indoors may include a tent.

Please state type of activity to be authorised, if not already stated, and give relevant further details, for example (but not exclusively) whether or not music will be amplified or unamplified.

State any seasonal variations for boxing and wrestling entertainment: For example (but not exclusively) where the activity will occur on additional days during the summer months.

Non standard timings. Where the premises intends to use the premises for the boxing or wrestling entertainment at different times from those listed above, please list: For example (but not exclusively), where you wish the activity to go on longer on a particular day e.g. Christmas Eve.

Will you be provisioning Live Music? No

Where will the performance of live music take place? Indoors may include a tent.

Please state type of activity to be authorised, if not already stated, and give relevant further details, for example (but not exclusively) whether or not music will be amplified or unamplified.

State any seasonal variations for performing live music: For example (but not exclusively) where the activity will occur on additional days during the summer months.

Non standard timings. Where the premises intends to use the premises for the performance of live music at different times from those listed above, please list: For example (but not exclusively), where you wish the activity to go on longer on a particular day e.g. Christmas Eve.

Will you be provisioning Recorded Music? No

Where will the playing of recorded music take place? Indoors may include a tent.

Please state type of activity to be authorised, if not already stated, and give relevant further details, for example (but not exclusively) whether or not music will be amplified or unamplified.

State any seasonal variations for playing recorded music: For example (but not exclusively) where the activity will occur on additional days during the summer months.

**Non standard timings. Where the premises intends to use the premises for the playing of recorded music at different times from those listed above, please list:
For example (but not exclusively), where you wish the activity to go on longer on a particular day e.g. Christmas Eve.**

Will you be provisioning Performances of dance? No

Where will the performance of dance take place? Indoors may include a tent.

Please state type of activity to be authorised, if not already stated, and give relevant further details, for example (but not exclusively) whether or not music will be amplified or unamplified.

State any seasonal variations for the performance of dance: For example (but not exclusively) where the activity will occur on additional days during the summer months.

Non standard timings. Where the premises intends to use the premises for the performance of dance at different times from those listed above, please list: For example (but not exclusively), where you wish the activity to go on longer on a particular day e.g. Christmas Eve.

Will you be provisioning anything with a similar description to live music, recorded music or Performances of dance? No

Please give a description of the type of entertainment that the club will be providing

Where will the entertainment take place? Indoors may include a tent.

Please state type of activity to be authorised, if not already stated, and give relevant further details, for example (but not exclusively) whether or not music will be amplified or unamplified.

State any seasonal variations for the entertainment: For example (but not exclusively) where the activity

will occur on additional days during the summer months.

Non standard timings. Where the premises intends to use the premises for the entertainment at different times from those listed above, please list: For example (but not exclusively), where you wish the activity to go on longer on a particular day e.g. Christmas Eve.

Will you be provisioning any late night refreshment? Yes

Monday Start Time 23:00

Monday End Time 00:00

Tuesday Start Time 23:00

Tuesday End Time 00:00

Wednesday Start Time 23:00

Wednesday End Time 00:00

Thursday Start Time 23:00

Thursday End Time 00:00

Friday Start Time 23:00

Friday End Time 00:00

Saturday Start Time 23:00

Saturday End Time 00:00

Sunday Start Time 23:00

Sunday End Time 23:30

Where will the provision of late night refreshment take place? Indoors may include a tent. On the premises

State any seasonal variations:For example (but not exclusively) where late night refreshment is provided on additional days during the summer months.

Non standard timings. Where the premises intends to use the premises for the provision of late night refreshment at different times from those listed above, please list: For example (but not exclusively), where you wish the activity to go on longer on a particular day e.g. Christmas Eve. Sundays before Bank Holiday Monday 2300-0000 Xmas Eve and NY Eve 2300-0100

Will you be provisioning any alcohol? Yes

Monday Start Time 10:00

Monday End Time 00:00

Tuesday Start Time 10:00

Tuesday End Time 00:00

Wednesday Start Time 10:00

Wednesday End Time 00:00

Thursday Start Time 10:00

Thursday End Time	00:00
Friday Start Time	10:00
Friday End Time	00:00
Saturday Start Time	10:00
Saturday End Time	00:00
Sunday Start Time	12:00
Sunday End Time	23:30
Where will the supplied alcohol be consumed?	Both on and off premises
State any seasonal variations : For example (but not exclusively) where the supply of alcohol will occur on additional days during the summer months.	
Non standard timings. Where the premises intends to use the premises for the supply of alcohol at different times from those listed above, please list: For example (but not exclusively), where you wish the activity to go on longer on a particular day e.g. Christmas Eve.	Sundays before Bank Holiday Monday 1200-0000 Xmas Eve and NY Eve 1000-0100
Name-First	Yasar
Name-Last	Koksal
Address	
Postcode	
Personal licence number (if known)	
Issuing licensing authority (if known)	Croydon Borough Council
Monday Start Time	10:00
Monday End Time	00:30
Tuesday Start Time	10:00
Tuesday End Time	00:30
Wednesday Start Time	10:00
Wednesday End Time	00:30
Thursday Start Time	10:00
Thursday End Time	00:30
Friday Start Time	10:00
Friday End Time	00:30
Saturday Start Time	10:00
Saturday End Time	00:30
Sunday Start Time	12:00
Sunday End Time	00:00
State any seasonal variations : For example (but not exclusively) where the supply of alcohol will occur	

on additional days during the summer months.

Non standard timings. Where you intend to use the premises to be open at different times from those listed above, please list: For example (but not exclusively), where you wish the activity to go on longer on a particular day e.g. Christmas Eve.

Sundays before Bank Holiday Monday 1200-0030 Xmas Eve and NY Eve 1000-0130

Please highlight any adult entertainment or services, activities, or other entertainment or matters ancillary to the use of the premises that may give rise to concern in respect of children.

None

General - all four licensing objectives (b,c,d,e): Please list here steps you will take to promote all four licensing objectives together.

The premises will operate as an Italian Restaurant. There has been a similar restaurant operation in place at this site during the last 15 years. The current owners are very experienced in the licensed restaurant trade having run restaurants during the past 20 years in London. CCTV will be installed, Staff will be trained, a refusals register will be maintained and Challenge 25 Age Verification Policy implemented. The nature of the business and the experience of the owners will not compromise the licensing objectives.

The prevention of crime and disorder:

CCTV will be installed, Staff will be trained, a refusals register will be maintained and Challenge 25 Age Verification Policy implemented. The nature of the premises and the licensable activities planned will not compromise this licensable activity . Suggested conditions
1.Digital CCTV and appropriate recording equipment to be installed ,operated and maintained in the premises to cover the counter and the entrance to the premises. The system shall be on and recording at all times the premises licence is in operation. a. The CCTV cameras and recording equipment must be of sufficient quality to work in all lighting levels inside the premises at all times. b. CCTV footage will be stored for a minimum of 28 days c. The CCTV images will record and display dates and times, and these times will be checked regularly to ensure their accuracy. d. The management will give full cooperation and technical assistance to the Police in the event that CCTV footage is required for the prevention and detection of suspected or alleged crime. e. Subject to Data Protection guidance and legislation, the management of the premises will ensure that key staff are fully trained in the operation of the CCTV, and will be able to download selected footage onto a disk for the police without difficulty or delay and without charge to Sussex Police. f. Any breakdown or system failure will be notified to the police via 'phone (currently 101) or email immediately and remedied within a time scale to be agreed with Sussex Police. 2. All staff members engaged, or to be engaged, in selling alcohol on the premises shall receive full training pertinent to the Licensing Act, specifically in regard age-restricted sales, and the refusal of sales to persons believed to be under the influence of alcohol or drugs. Induction training must be completed prior to engaging in any sale of alcohol. Refresher training shall be conducted thereafter at intervals of no more than six months. All restricted sales training undertaken by staff members shall be fully documented and signed by the employee and the DPS. All training records shall be made

immediately available upon request to officers of a Responsible Authority. 3. A refusals record must be kept at the premises which details all refusals to sell alcohol. This record must include the date and time of the incident, a description of the customer, the name of the staff member who refused the sale and the reason the sale was refused. All entries must be made within 24 hours of the refusal. The DPS must review and sign the record at intervals of no more than eight weeks. The record must be made immediately available upon request to officers of a Responsible Authority.

Public safety:

All safety certificates will be up to date.

The prevention of public nuisance:

The nature of the premises and the licensable activities planned will not compromise this licensable activity.

The protection of children from harm:

Staff will be trained, a refusals register will be maintained and Challenge 25 Age Verification Policy implemented Suggested Condition 4. The premises will operate an age verification policy set at a minimum of 25 years, whereby any person attempting to buy alcohol who appears to be under the specified age will be asked for photographic ID to prove their age. Signage advertising the "Challenge" policy will be displayed in prominent locations in the premises and shall include the point of sale and the area where the alcohol is displayed, as a minimum.

I have included documents demonstrating my entitlement to work in the United Kingdom or my share code issued by the Home Office online right to work checking service-I have included documents demonstrating my entitlement to work in the United Kingdom or my share code issued by the Home Office online right to work checking service no

Please attach documents demonstrating your entitlement to work in the United Kingdom.

I understand I am not entitled to be issued with a licence if I do not have the entitlement to live and work in the UK (or if I am subject to a condition preventing me from doing work relating to the carrying on of a licensable activity) and that my licence will become invalid if I cease to be entitled to live and work in the UK (please read guidance note 15-I understand I am not entitled to be issued with a licence if I do not have the entitlement to live and work in the UK (or if I am subject to a condition preventing me from doing work relating to the carrying on of a licensable activity) and that my licence will become invalid if I cease to be entitled to live and work in the UK (please read guidance note 15 no

The DPS named in this application form no

is entitled to work in the UK (and is not subject to conditions preventing him or her from doing work relating to a licensable activity) and I have seen a copy of his or her proof of entitlement to work, or have conducted an online right to work check using the Home Office online right to work checking service which confirmed their right to work-The DPS named in this application form is entitled to work in the UK (and is not subject to conditions preventing him or her from doing work relating to a licensable activity) and I have seen a copy of his or her proof of entitlement to work, or have conducted an online right to work check using the Home Office online right to work checking service which confirmed their right to work

Please indicate your agreement by entering your name

Date 03/07/2021

Capacity

Address for correspondence associated with this application

Postcode

Phone

Correspondence Email

Confirm Email

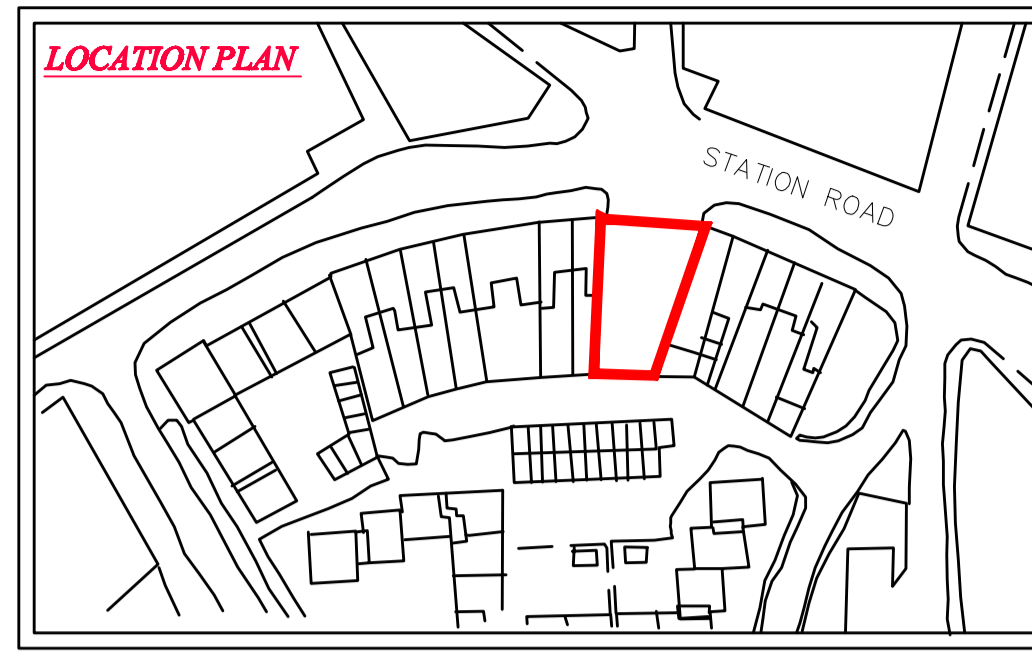

DOOR SCHEDULE

FOR DOOR TYPES PLEASE REFER TO THE SPECIFICATION OF THE SPECIFICATION

TYPE A D16
 TYPE B D04, D09
 TYPE C D19
 TYPE D D17, D18
 TYPE E D15
 TYPE F D11, D13
 TYPE G D08, D12
 TYPE H D05
 TYPE I D06, D10
 TYPE J D14
 TYPE K D03
 TYPE L D07, D20, D15

D01- NEW PART-GLAZED TIMBER DOOR WITH TIMBER LOWER PANELS SEE DRAWING FOR DETAILS
 D02- DORMER LOBBY DOOR WITH MANTLE FIXINGS & GLASS SIDE PANEL & FAN LIGHT.

HATCHING KEY

100mm METAL STUD WALL
 EXTERIOR QUALITY BRICKWORK
 100 X 440 X 215 BLOCKWORK
 140 X 440 X 215 STRUCTURAL BLOCKWORK
 215 BRICK WALL
 BLACK GRANITE TILES
 MIRROR
 OUTLINE OF MEZZANINE FLOOR
 BULKHEAD
 SERVICES
 THE STUB STACK POSITION ARE INDICATED BY THE SYMBOL
 ALL STUB STACK CONNECTORS ARE TO BE Laid 50mm AWAY FROM THE WALLS TO ALLOW FOR PLASTER, TILES & CONNECTION COLLARS.
 50MM WASTES
 100MM BELOW GROUND
 100MM ABOVE GROUND

Fire Protection Indication/ Equipment Key

FIRE ALARM CALL POINT (BS5839)
 AREA COVERED BY SMOKE DETECTORS (BS5839)
 AREA COVERED BY HEAT DETECTORS (BS5839)
 AREA COVERED BY NON MAINTAINED EMERGENCY LIGHTS
 THE 'FIRE EXIT' SIGN IS TO BE SUSPENDED ABOVE HEAD HEIGHT AT RIGHT ANGLE TO THE ESCAPE ROUTE MINIMUM SIZE OF LETTERING 75mm OR EQUIVALENT GRAPHIC RUNNING MAN SYMBOLS
 INDICATES THAT THE NOTICE IS ILLUMINATED
 SIDES OF DOOR
 SIGN 'FIRE DOOR KEEP LOCKED' 5mm LETTERING
 SIGN 'FIRE DOOR KEEP CLEAR' 5mm LETTERING
 9 LITRE WATER EXTINGUISHER
 2kg CARBON DIOXIDE EXTINGUISHER
 9kg DRY POWDER EXTINGUISHER
 FIRE BLANKET
 FIRE ALARM SOUNDERS
 NON-MAINTAINED EMERGENCY LIGHT
 MAINTAINED EMERGENCY LIGHT
 NON-MAINTAINED FLOODLIGHT
 FIRE ALARM PANEL

NOTES

1 DIMENSIONS AND LEVELS
 FIGURED DIMENSIONS AND LEVELS SHOULD BE VERIFIED BY THE CONTRACTOR ON SITE BEFORE CONSTRUCTION OR MANUFACTURE AND ANY DISCREPANCIES BROUGHT TO THE ATTENTION OF THE CONTRACT ADMINISTRATOR. DIMENSIONS SHOULD NOT BE SCALED. PLAN ENLARGEMENTS OR COPIES OF O.S. MAPS DYELINE PRINTS ETC MAY CONTAIN INACCURACIES IN DIMENSIONS OR LEVELS

COPYRIGHT FOR ALL DESIGN AND DRAWINGS IN WHOLE OR PART SHALL REMAIN WITH THE DESIGNER

REV A	POSITION OF FIRE EXIT DOOR CHANGED	08-02-1999
REV B	POSITION OF FIRE EXIT DOOR CHANGED	27-04-1999
REV C	INTERNAL LOBBY AREA AREA OF MEZZANINE FLOOR INCREASED CAFE STYLED DOORS TO HAVE FIXED BOTTOM PANELS WALL THICKNESS CHANGES	11-05-1999
REV D	AMENDMENTS TO FIRE EXIT AMENDMENTS TO ENTRANCE LOBBY AREA ADDED A REFUSE STORE	10/06/99
REV E	AMENDED ENTRANCE LOBBY - PLANNING	14/06/99
REV F	AMENDED FURTHER TO SITE INVESTIGATIONS	29/06/99
REV G	NOTE REGARDING SEATING NOS ADDED	05/07/99
REV H		30/07/99

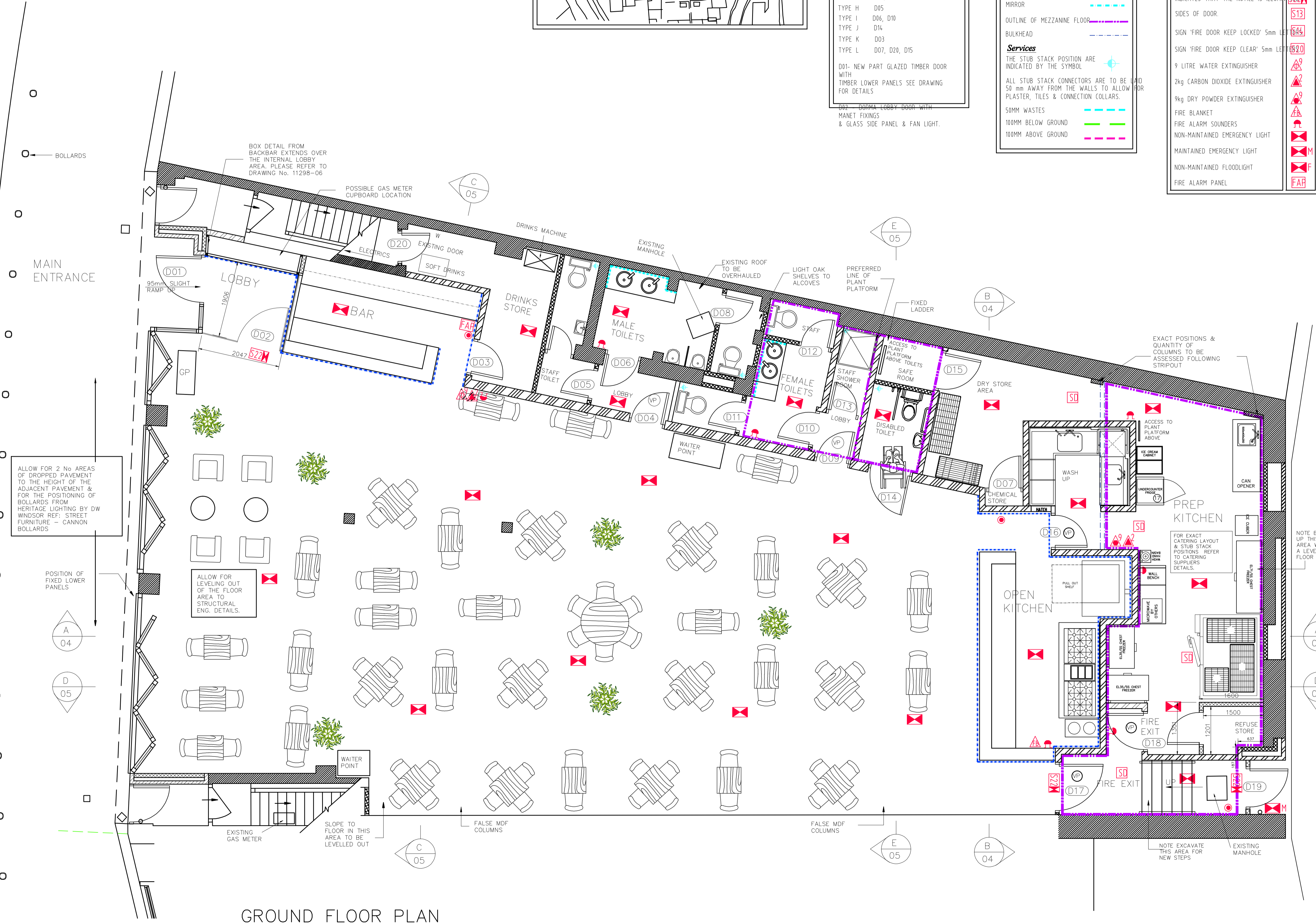

SEATING CAPACITY

RESTAURANT	100
BAR/SERVERY	4

NB: AT THE MAXIMUM NUMBER OF PERSONS PERMITTED 120MM

RE-ISSUED DOCUMENT

No	REVISION	DATE
A	04	
D	05	

CLIENT: **ASK RESTAURANTS LTD**

CARRINGTON DESIGN CONSULTANTS STEVENS

THE STUDIO 188 HIGH STREET BARNET HERTFORDSHIRE EN5 5SZ
 TELEPHONE: 0181 441 4642 FAX: 0181 440 8476

LOCATION: 25-27 STATION ROAD, BURGESS HILL WEST SUSSEX

DRAWING TITLE: PROPOSED GROUND FLOOR PLAN

SCALE	DATE	PROJECT No	DRAWING No	REVISION	DRAWN BY
1:100@A3 1:50@A1	10-12-98	11298	11298-02	G	LCS/BMC

THE CONTENTS OF THIS DRAWING ARE THE COPYRIGHT OF CARRINGTON STEVENS LTD