



as was...



Under Way ...



Completed



Milton House

Milton House was built as an office building in the 1960s. It was latterly used by Her Majesty's Court Service but vacated in 2010. Arch Industries bought the empty building and site (which housed a car washing facility) in 2014 and then applied for, and achieved, planning consent to convert and extend the existing building by adding a new floor onto the existing office building and building a new adjoining block on the southern part of the site.

The development houses 28 high quality apartments, all of which sold prior to completion of the development work in 2016 and are now occupied. Arch Industries sought to raise the bar for apartment development in the town focussing on top quality design with particular attention to pleasing communal areas.

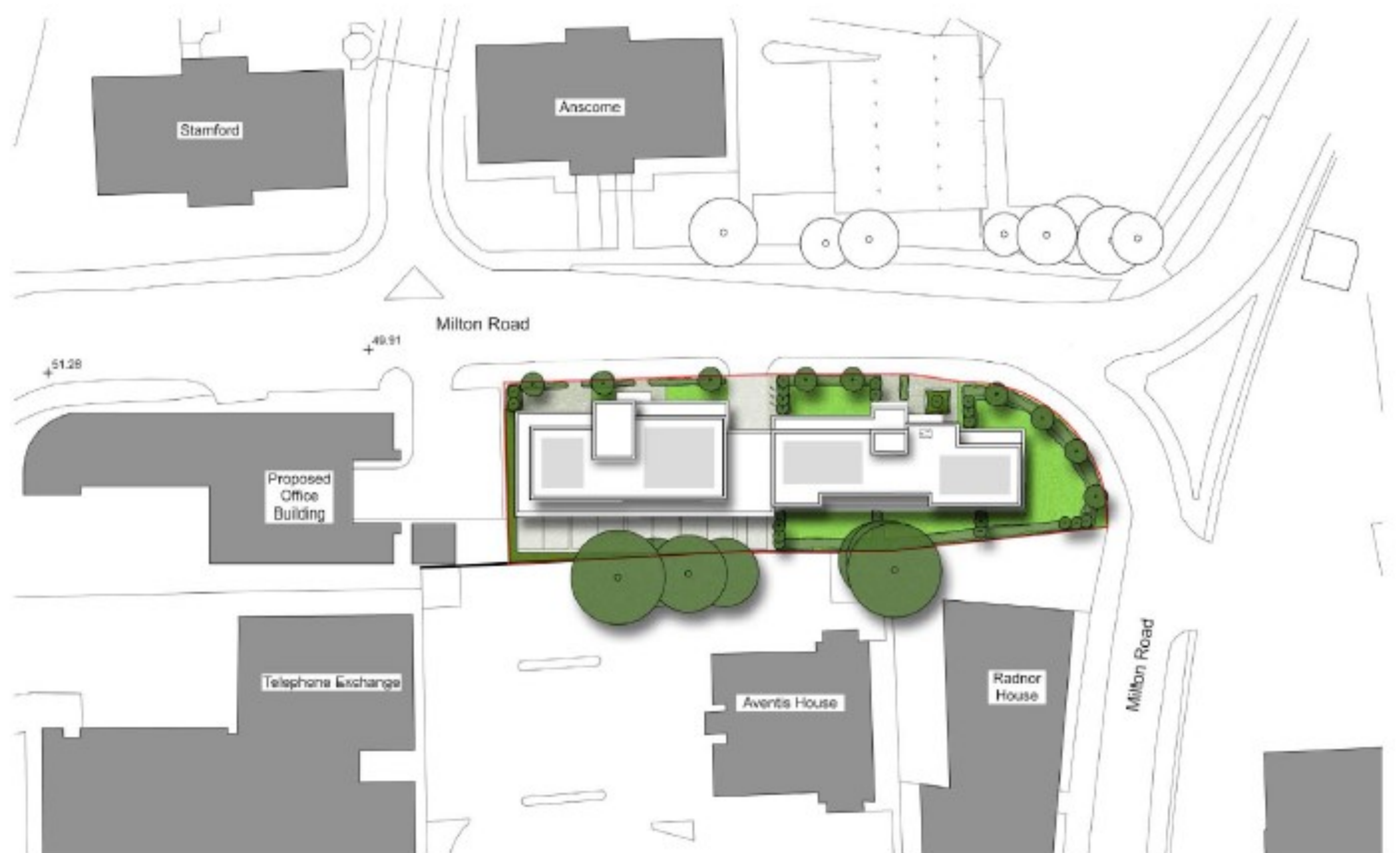

First and Second Floor